

FRPRO EVO HD: new digital programmable profiler

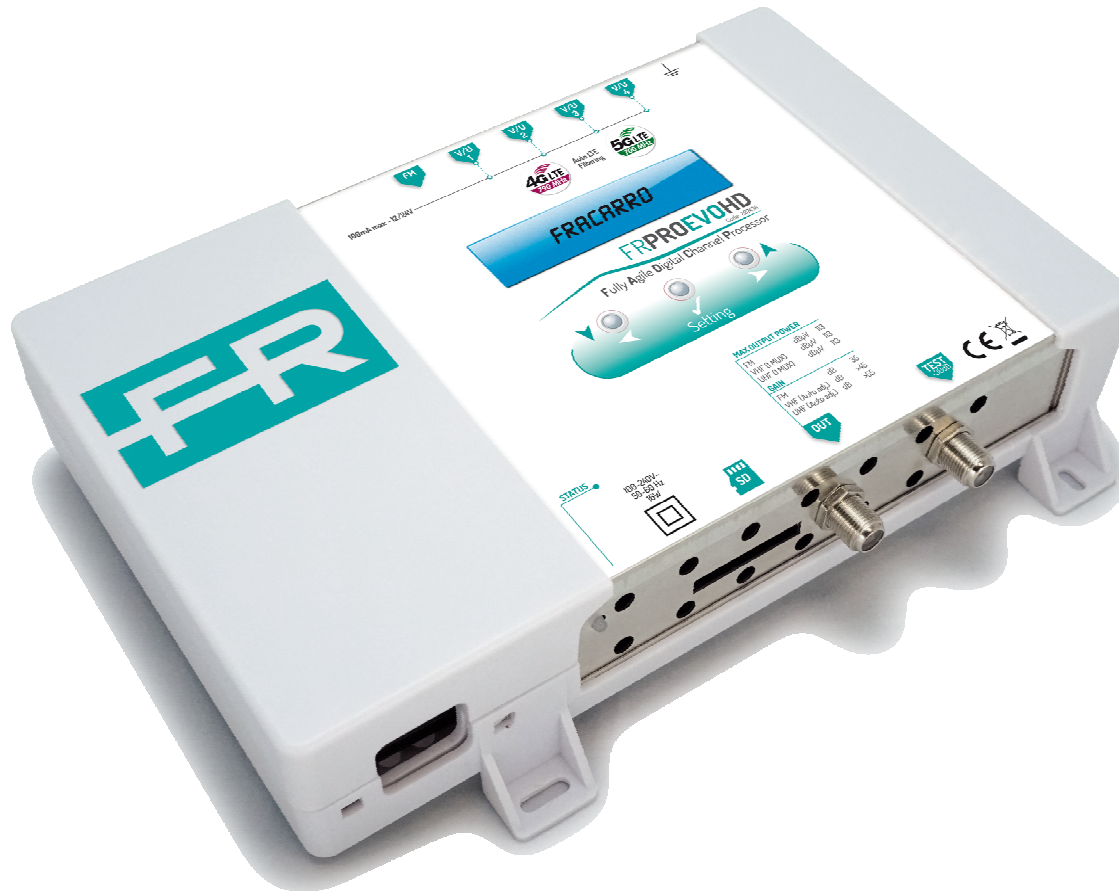

Digital Terrestrial filtering, equalization and amplification at the highest levels!



fracarro.com

FRACARRO
shaping the future

The evolution of TV filtering and equalization!!

✓ **The FRPRO EVO HD** is a "Flexible" Digital Terrestrial Channels compact processor able to filter, convert, amplify and perfectly distribute many DVB-T2/T digital terrestrial multiplexes available in VHF/UHF band and guarantee a perfect stabilized signal in every condition. In this way all the distributed TV programs are correctly available in every coaxial system socket

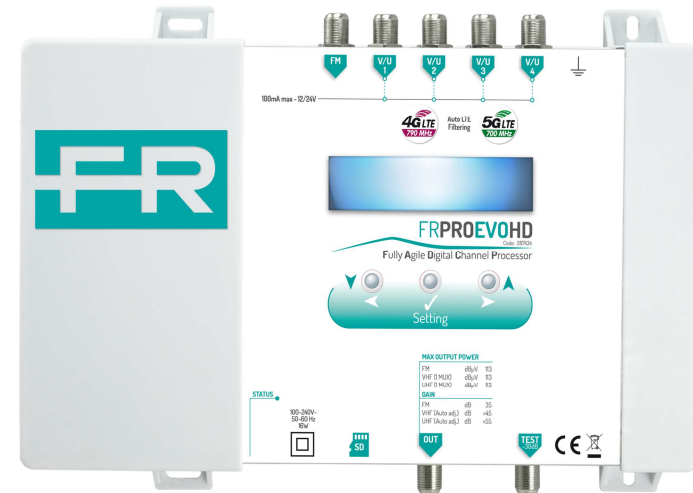

The ideal answer for every type of TV system distribution



fracarro.com

FRACARRO
shaping the future

The evolution of TV filtering and equalization!!

Perfect signal in every single TV socket!!

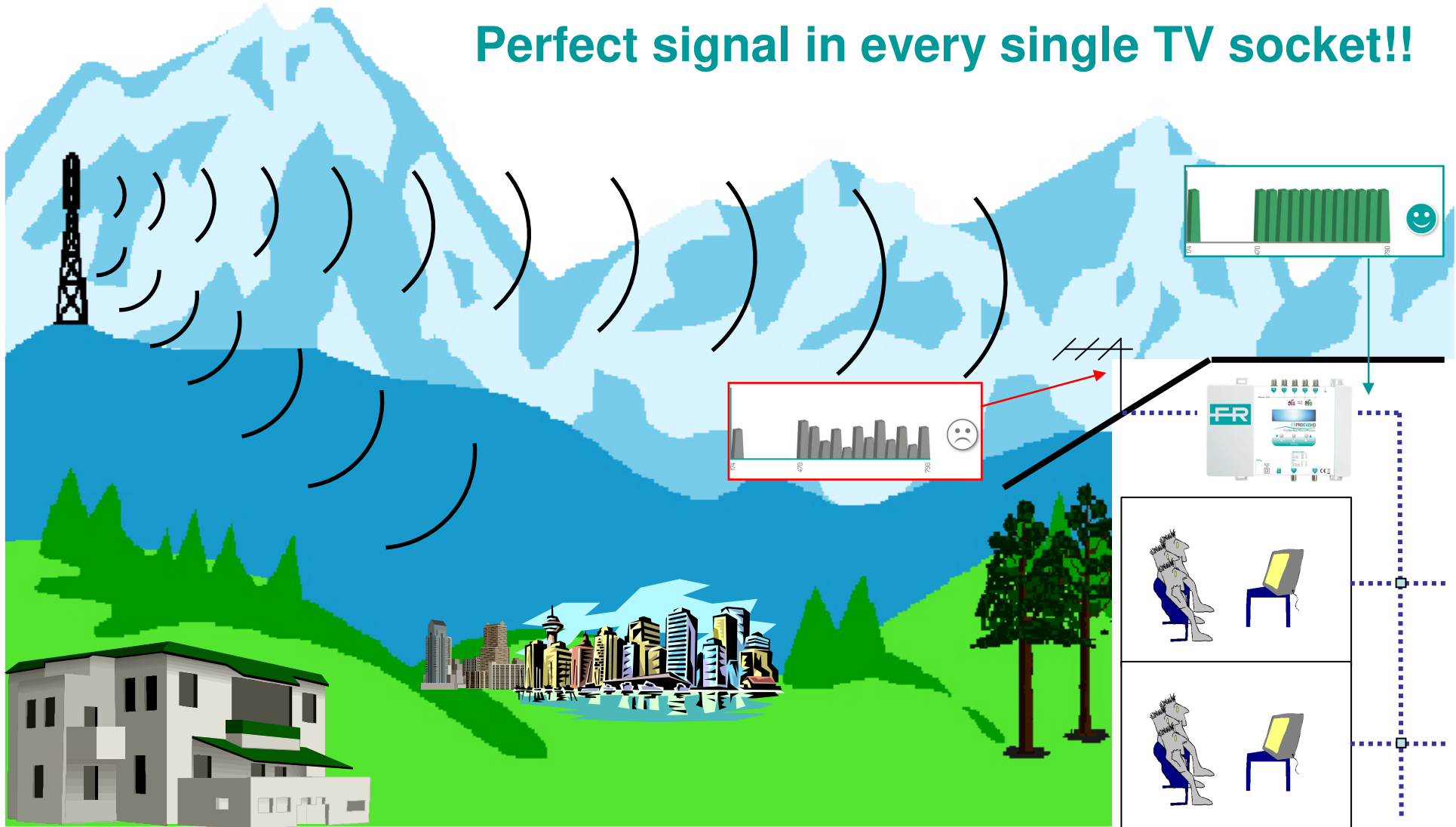

fracarro.com

FRACARRO

shaping the future

Iso-frequency filtering or TV channels processor?

✓ **FRPRO EVO HD** is an advanced and programmable digital profiler, able to satisfy the filtering or channel conversion's needs of many digital terrestrial frequencies.

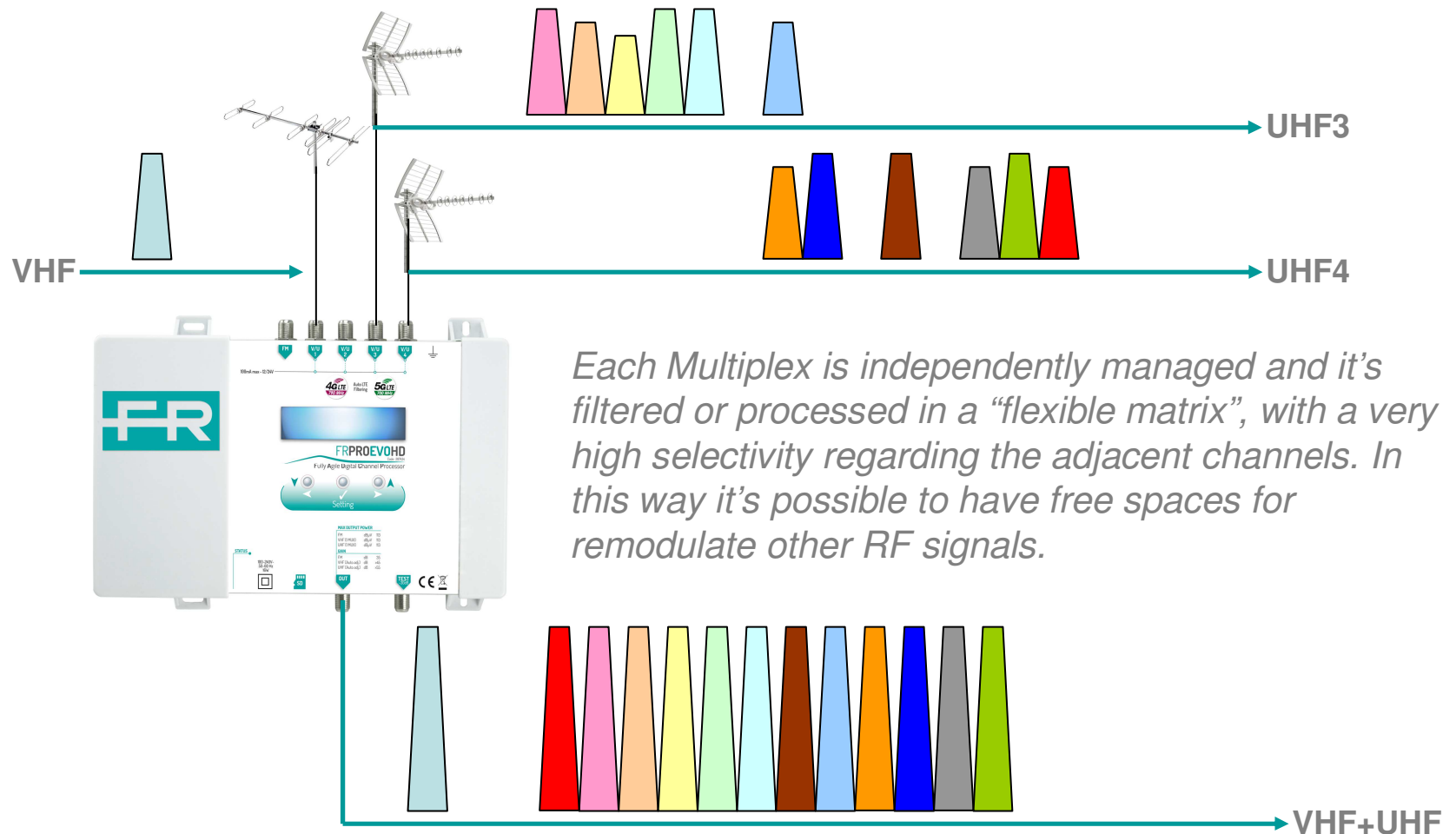

“Real Time” Automatic Gain Control Circuit

✓ The **innovative technology** used in **FRPRO EVO HD** guarantees a perfect stabilization of the received multiplexes, in fact the **FRPRO EVO HD** compact profiler offers an Automatic Gain Control system with very high dynamic range that operates **“in Real Time”** mode on each terrestrial digital multiplex managed in VHF or UHF band.

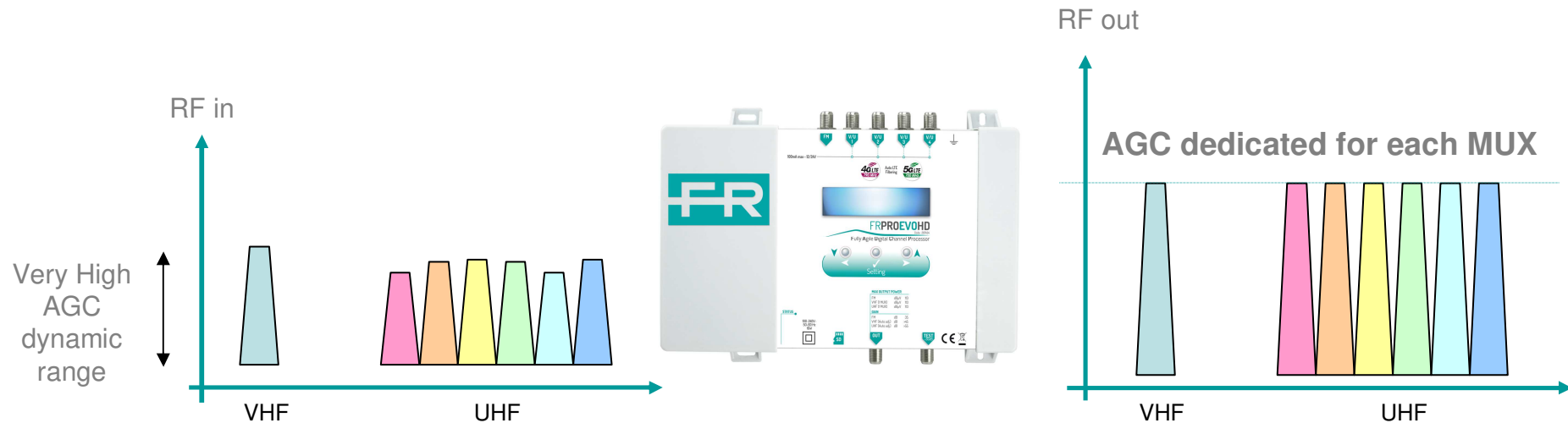

The absolute guarantee of the perfect signal in any TV socket, even in the most complex systems.



fracarro.com

FRACARRO

shaping the future

Auto LTE filtering

- ✓ The **FRPRO EVO HD** digital compact profiler automatically applies the most suitable LTE filtering depending on the terrestrial digital channels managed from the UHF inputs (**4G/790, 5G/700 or disabled**).

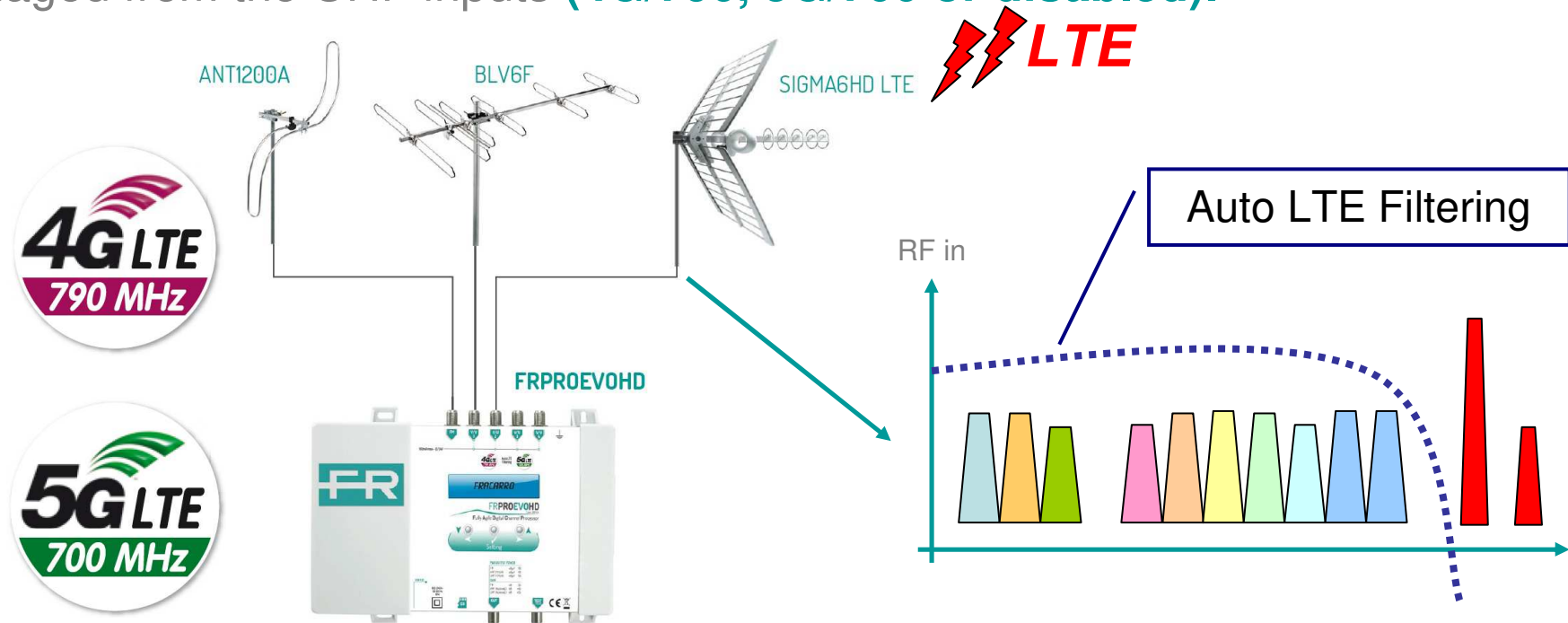

High protection against the LTE interferences !!



fracarro.com

FRACARRO
shaping the future

Easy installation

✓ Thanks to the 4 VHF-UHF programmable wideband inputs and the FM auxiliary input **its possible to flexible distribute signals coming from different directions.** In fact, there are particular situations in which we need to use different antennas, different multiband amplifier's models with different inputs characteristics.



“FUTURE-PROOF”: the availability of four independent and programmable VHF / UHF flexible inputs guarantees a product ready for future changing



fracarro.com

FRACARRO

shaping the future

Quick and secure settings!!

✓ It's possible to quickly setup the **FRPRO EVO HD** digital terrestrial compact headend through the three buttons and on-board display.

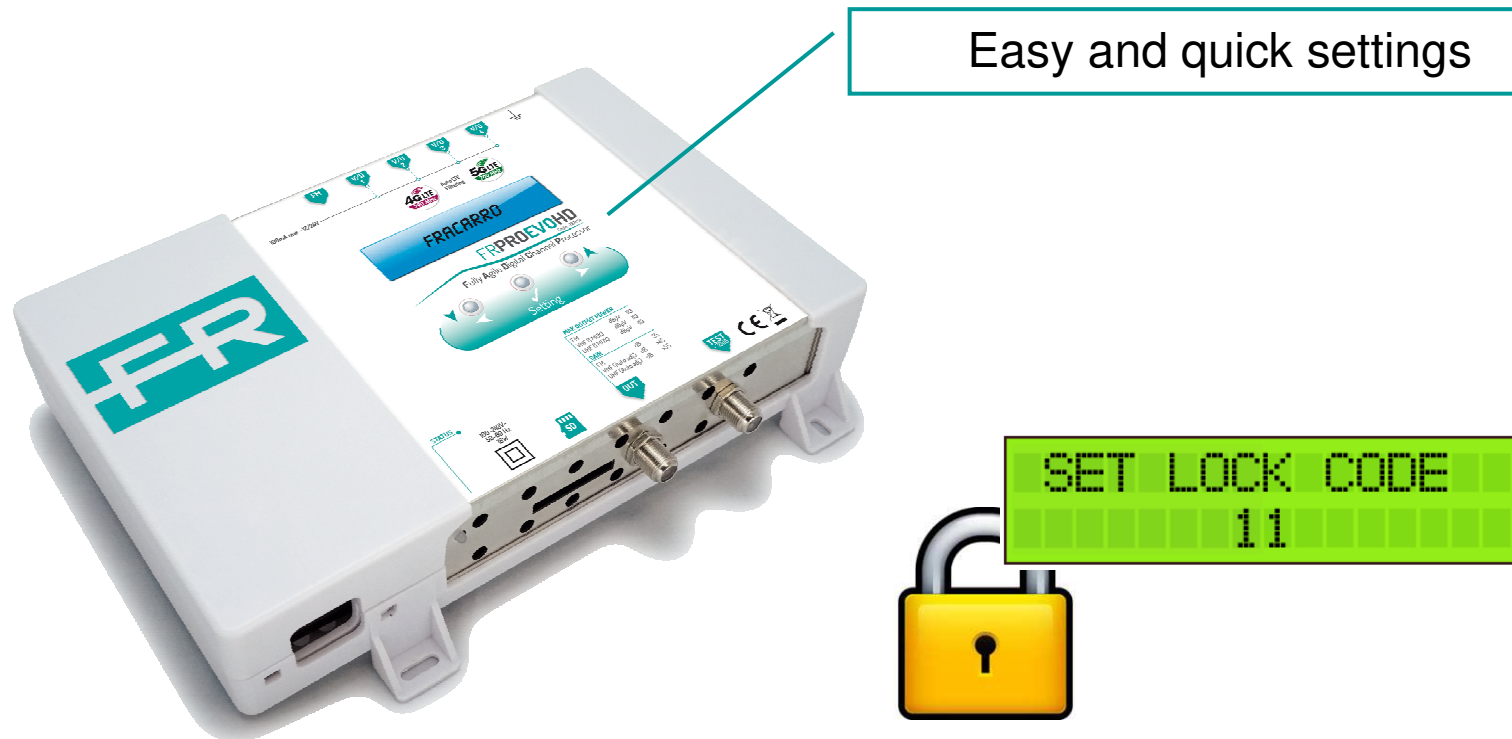

✓ The Digital Compact Profiler offers the possibility to enter a **PIN code** to protect the settings. In this way the installer is sure to be protected against tampering of the FRPRO EVO HD.

SD Card slot

- ✓ The Compact Headend allows you to save the configuration on an external **SD card memory**, recovering the programming at any time or exporting the configuration to another **FRPRO EVO HD** digital profiler

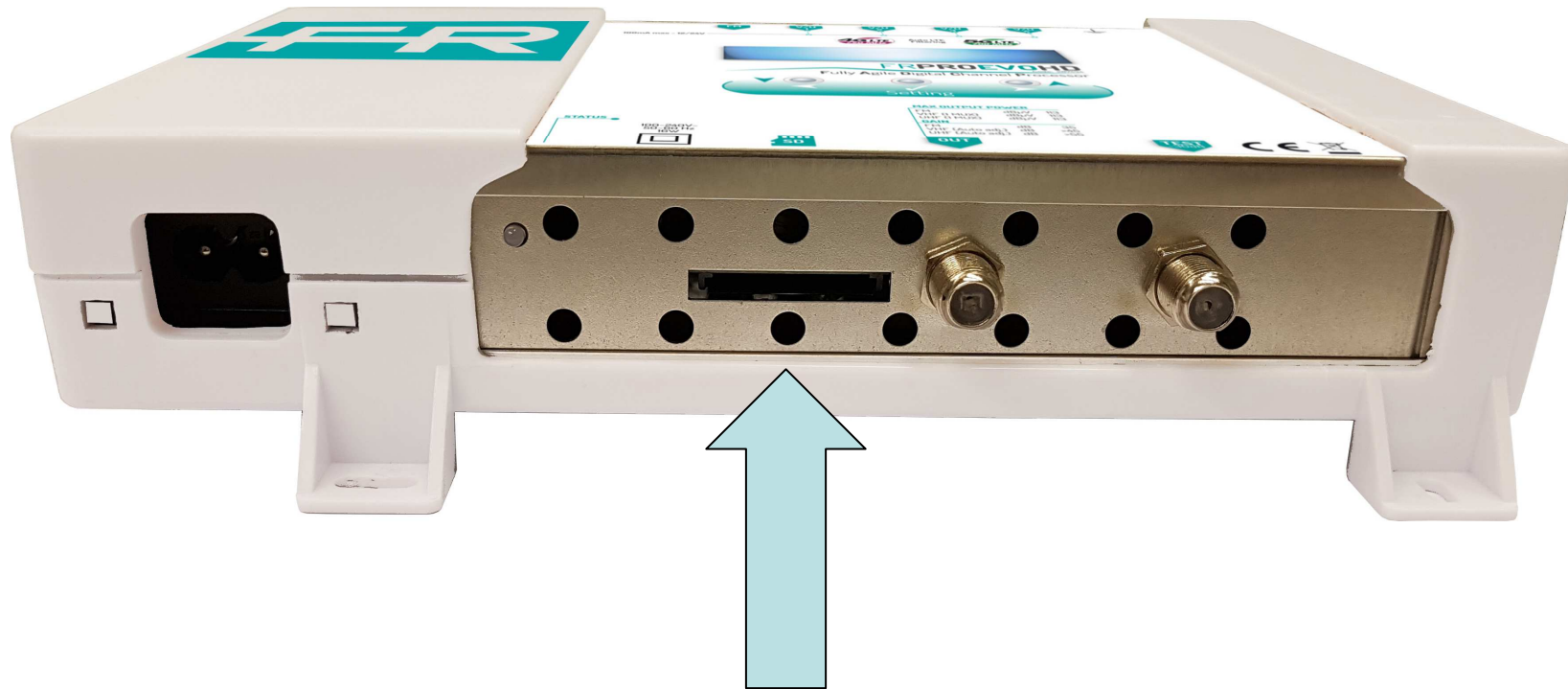

Quick maintenance...

✓ The **FRPRO EVO HD** power supply can be easily removed “on the field” and can be replaced with another certificate one and with the same or higher technical features, minimizing any disruption to the end user.

NOTE: the replacement power supply may be larger than the previous one, but this does not preclude its correct operation.

093924 PSU-12V3A-1PIN



287376 PSU1340TS



fracarro.com

FRACARRO

shaping the future

FRPRO EVO HD... in details...

FM input

4x VHF-UHF programmable inputs
(12/24V remote supply enable during settings)

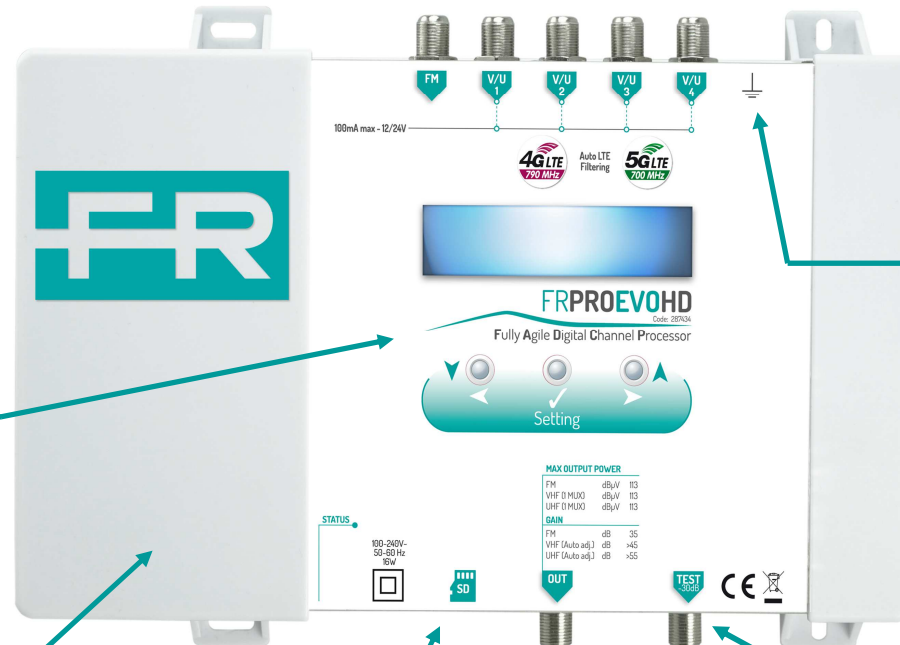

Grounding
fixing

Display and three
buttons for settings

Power Supply
cover

TEST -30dB

SD Card slot

RF Output



fracarro.com



FRPRO EVO HD block diagram

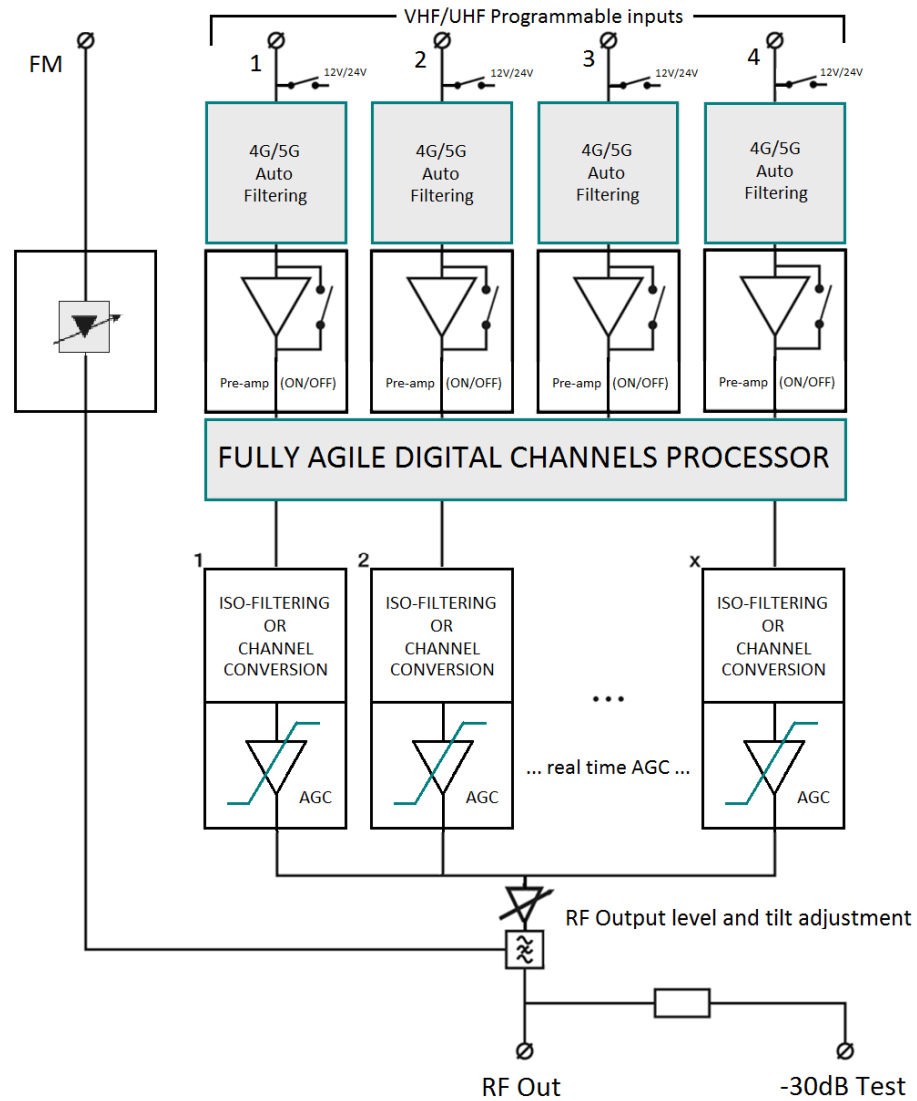

FRPRO EVO HD: the solution for an always perfectly equalized Digital Terrestrial signal

